



Pembina Pipeline Corporation Community Update

Life in the Heartland Community Information Evening

Wayne Carey – Manager, Field Projects, Redwater Facility

October 23, 2017



Forward-Looking Statements



This presentation is for information purposes only and is not intended to, and should not be construed to constitute, an offer to sell or the solicitation of an offer to buy, securities of Pembina Pipeline Corporation. This presentation and its contents should not be construed, under any circumstances, as investment, tax or legal advice. Any person accepting delivery of this presentation acknowledges the need to conduct their own thorough investigation into Pembina and its activities before considering any investment in its securities.

In the interest of providing investors with information regarding Pembina, including management's assessment of Pembina's future plans and operations, certain statements and information contained in this presentation constitute forward-looking statements or information within the meaning of the "safe harbour" provisions of applicable securities legislation. Such forward-looking information and statements relate to business strategy and plans, expected capital costs, incremental volumes and in-service dates, expansion and diversification opportunities, anticipated community benefits including employment opportunities, and other expectations, beliefs, goals, objectives, assumptions or statements about future events or performances. Undue reliance should not be placed on these forward-looking statements and information as both known and unknown risks and uncertainties may cause actual performance and financial results to differ materially from the results expressed or implied.

Forward-looking statements and information are based on Pembina Pipeline Corporation's expectations, estimates, projections and assumptions in light of its experience and its perception of historical trends as well as current market conditions and perceived business opportunities. These statements are not guarantees of future performance and are subject to a number of known and unknown risks and uncertainties including but not limited to: the impact of competitive entities and pricing; reliance on key alliances and agreements; the strength and operations of the oil and natural gas industry and related commodity prices; regulatory environment; fluctuations in operating results; the availability and cost of labour and other materials; the ability to finance projects on advantageous terms; and tax laws and tax treatment. Additional information on these factors as well as other factors that could impact Pembina's operational and financial results are contained in Pembina's Annual Information Form and Management's Discussion and Analysis, and described in our public filings available in Canada at www.sedar.com and in the United States at www.sec.gov. Readers are cautioned that this list of risk factors should not be construed as exhaustive.

The forward-looking statements contained in this document speak only as of the date of this document. Except as expressly required by applicable securities laws, Pembina and its subsidiaries assume no obligation to update forward-looking statements and information should circumstances or management's expectations, estimates, projections or assumptions change. The forward-looking statements contained in this document are expressly qualified by this cautionary statement.

Redwater Fractionation and Storage (RFS) Facility



A responsible operator and member of the community for over 40 years.

Pembina's Vision: For our stakeholders to view us as being the leader in the Canadian energy infrastructure sector.

1. We ensure no harm to people or the environment
2. We are the 'first choice' by customers to cost-effectively and reliably connect them to markets
3. We provide sustainable industry-leading returns to our shareholders
4. We have a trustworthy, respectful, collaborative and fair work culture making us the 'employer of choice'
5. We set the standard for harmonious relationships with all of our stakeholders

This is the 'Purpose' of Pembina

Pembina's Heartland Operations

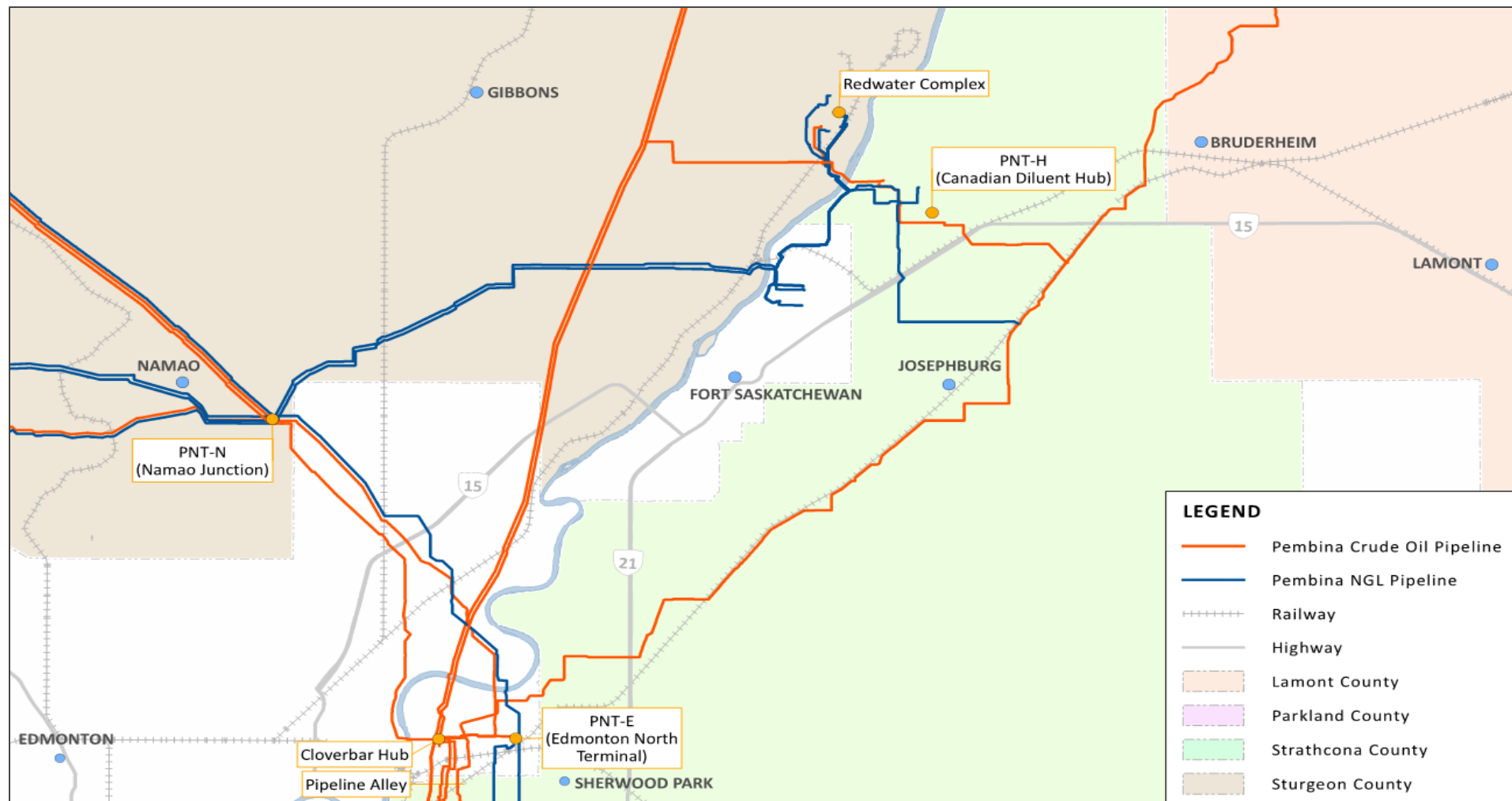

Pembina's Heartland facilities and pipelines are well-connected.

Our Business – What We Do at RFS

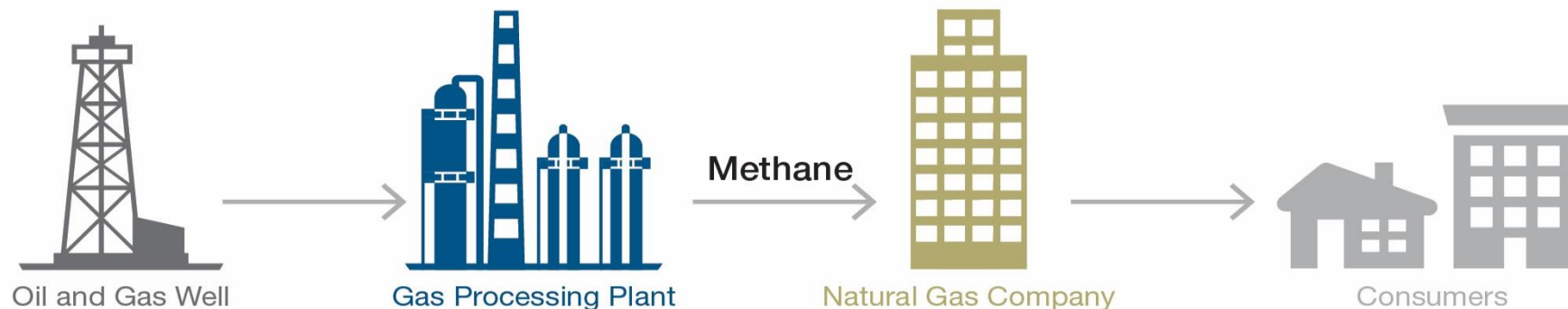

Pembina separates NGLs from the gas stream at our gas plants, then ships the raw NGLs through our pipeline network to RFS where they are fractionated into their more valuable components before either being stored or shipped to market.

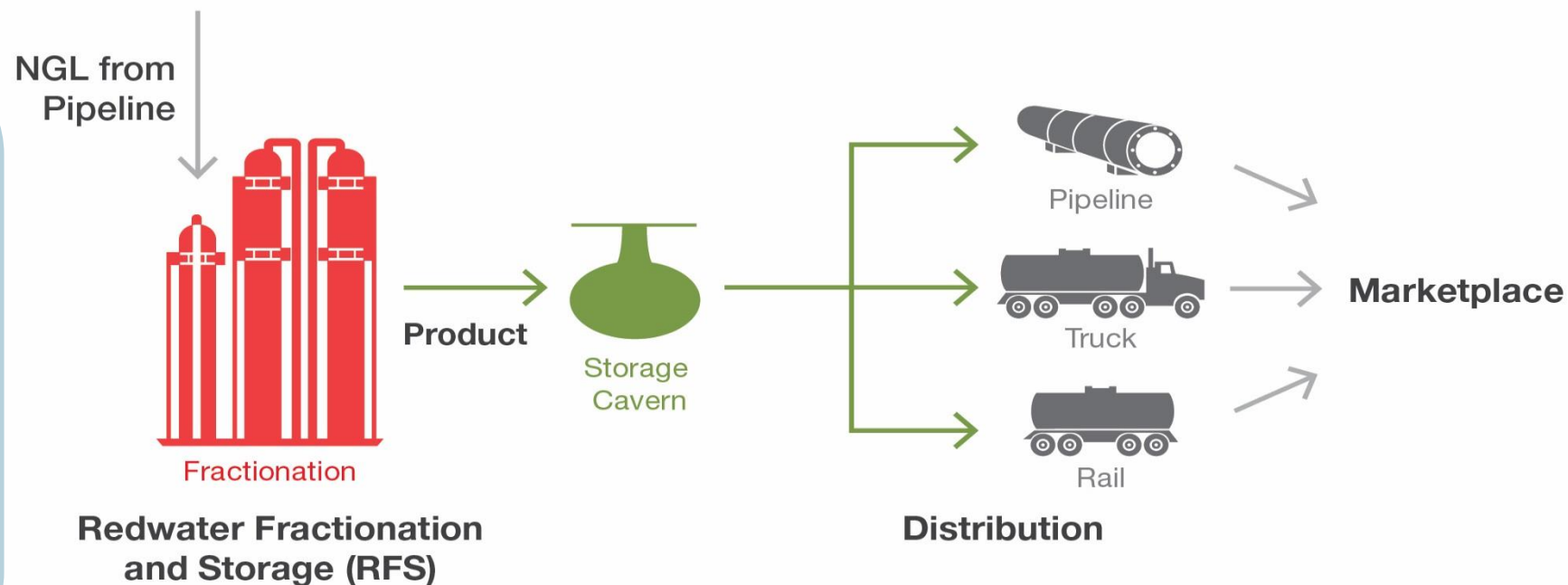

Working at Pembina – the ‘Employer of Choice’



Employee summary



Recognized for being a top employer



An employee culture that gives back



Employee engagement and turnover

Engagement Score:
75%
above energy sector average of 63%

2016 Voluntary
Turnover Ratio:
2.67%
low relative to industry average

One of Pembina's most valuable assets are its dedicated people that come to work every day.

⁽¹⁾ This is well above our peers, which average \$0.25. Data based on a 2017 independent audit of Pembina's 2016 Community Investment program.

Community Engagement



Life in the Heartland Events



Mayor's Breakfasts



Facility Tours



Grand Opening Celebrations

Pembina readily participates in local initiatives that enhance community and industrial development.

- Municipal Events
 - Mayor's Breakfast
 - Economic Development Initiatives
- Community Information Nights
- Facility Tours and Grand Openings

Contributing to the success of the local community is an investment in our business.

Supporting the Local Economy



Pembina's projects and operations support local businesses and municipalities through:

- Materials and service vendors
- Local contractor procurement
- Employee wages and local expenditures
- Property taxes

Pembina's total spend in the Heartland Region*:

- **2016: \$28,633,380.09**
- **2017 (to date): \$26,187,605.15**



The Heartland Region is home to ~75 Pembina Employees and Payroll Contractors

* = based on billing address on purchase orders

Giving Back to our Community



Fuel 4 Thought School Breakfast



Redwater Tree Planting Project



Pembina supports non-profit and charitable organizations that are based in, or support, the communities where we operate.

Within this framework, we focus our investments on four key funding areas:

- Education
- Safety and Environment
- Community Building
- Health and Recreation

Please visit the Community Investment page on website (pembina.com) for application details.

Hockey Alberta Bumper Pad Grant Program



Fire Safety Grant Program



If you have questions, please contact community_investment@pembina.com

RFS Rail Yard Expansion Project



- Construction of ~36 km of track
- Realignment of 9 km of track is complete
- Four new stormwater ponds are complete
- New track installation is 15% complete
- Some new tracks will be in service by May 2018, with more following during summer
- Project completion on track for Q4 2018



Pembina's Rail Expansion at RFS is the largest project of its kind in Canada.

RFS Cogen Project

- Natural Gas Turbine Generator
- Produces electricity and heat to support RFS2/RFS3 Fractionators
- Reduce the net carbon emissions by up to 30 percent
- Reduce carbon emissions from traditional processing sources by up to 70%
- In service mid-2019 subject to regulatory and environmental approvals

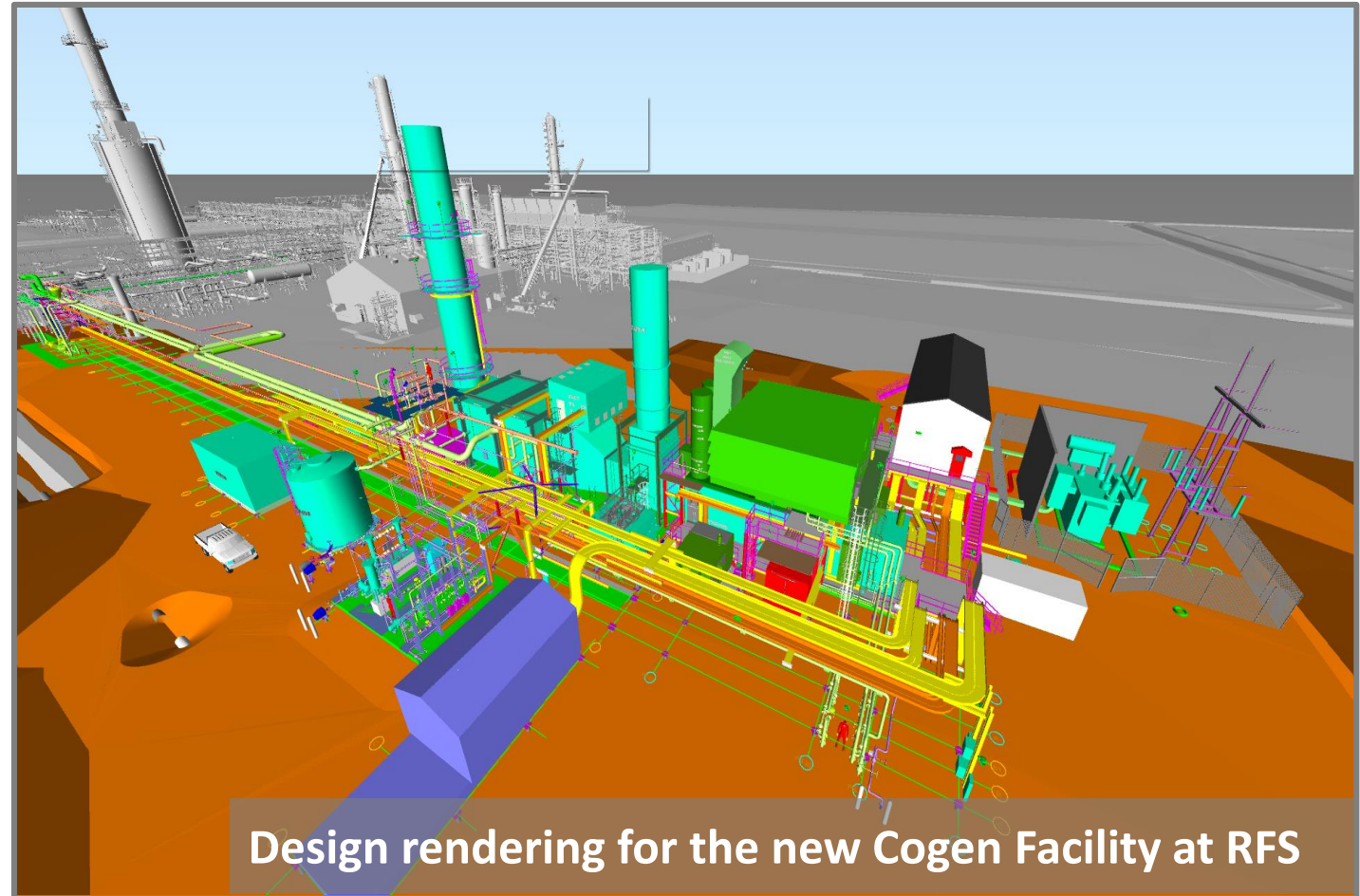

Design rendering for the new Cogen Facility at RFS



Alberta Propane Dehydrogenation ("PDH") & Polypropylene ("PP") Project Overview

CANADA KUWAIT
PETROCHEMICAL  CORPORATION

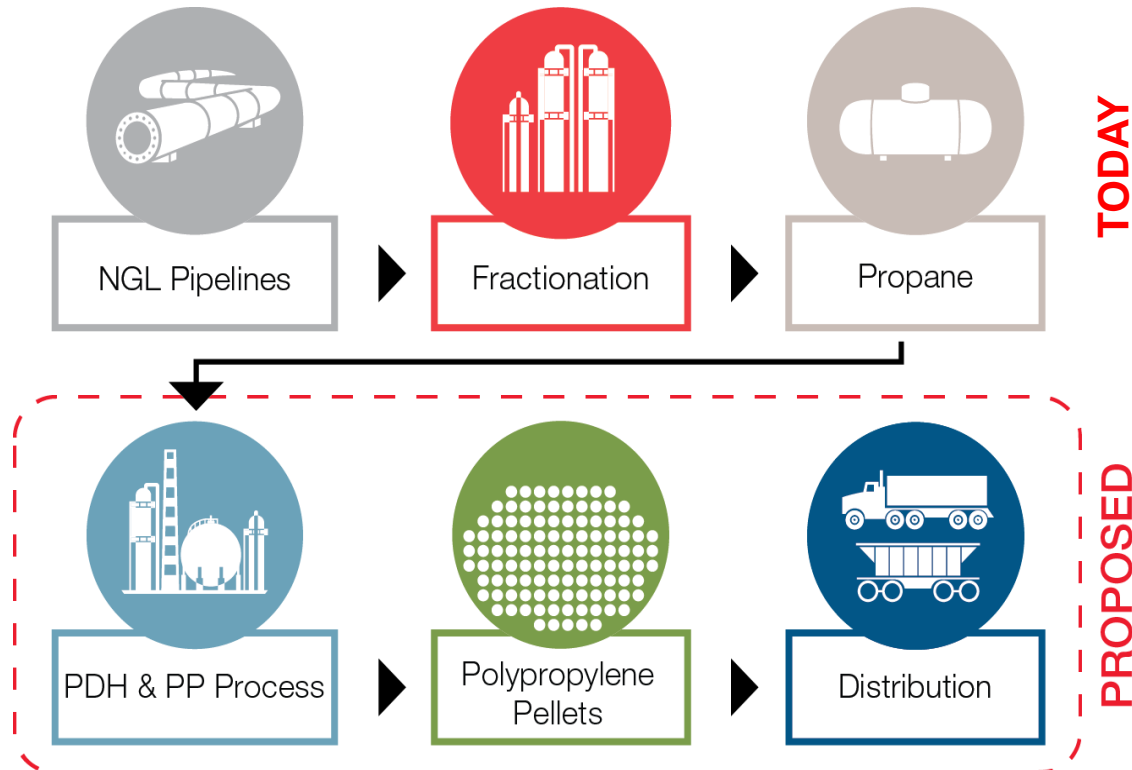

- CKPC is developing a world-scale, integrated PDH and PP production facility in Sturgeon County
- Facility would convert locally produced liquid propane into solid PP recyclable pellets
 - Opportunity to add value locally → currently Alberta produces 5x more propane than it consumes
 - A 'made in Canada solution' → Canada is currently 100% reliant on imported PP
 - PP is the 2nd most commonly used material to make plastic
- The \$4 BB project presents substantial economic benefits
 - 14,000+ person years of employment through construction
 - ~36,000 person years of employment through the economic life of the project (direct, indirect and induced job creation)
 - Increased local tax base and local community investment
- Project conditionally awarded \$300 million in royalty credits from Alberta Energy

Note: Project remains subject to a positive final investment decision from each partner of the joint venture, as well as regulatory and environmental approvals.



Thank You

SOMEONE IS
WAITING FOR YOU
TO GET HOME
**PLEASE DRIVE
SAFELY**

PEMBINA